



Delmer B.V.
Hogeschoollaan 231
5037 GC Tilburg
The Netherlands

Tools & Equipment
For Retail and Craftsman

Delmer Electric Mini Dumper Manual & CE



CONGRATULATIONS

Thank you for purchasing a new E dumper.

We have done our utmost to ensure your E dumper will be the most trouble-free and productive machine you will ever use. Please carefully read through this entire Operator's Manual before using this unit. Pay special attention to the cautions and warnings.



Delmer B.V.
Hogeschoollaan 231
5037 GC Tilburg
The Netherlands

**Tools & Equipment
For Retail and Craftsman**

HINTS FOR SAFE OPERATION

- DO** study this manual before operating your E dumper.
- DO** check all nuts, bolts, and wheel studs regularly.
- DO** use appropriate work clothing, including a protective helmet and safety shoes.
- DO** exercise extreme caution with the controls when working on steep or slippery surfaces, especially when people are near the working area.
- DO** always drive the machine with both hands on the steering handlebar.
- DO** ensure that all safety guards are in place when operating the E dumper.

ATTENTION

- DO** keep the E dumper free of any accumulation of dirt, grease, oil, or other flammable materials.
- DO** connect the dumper to the supplied battery charger after use. The battery charger should remain powered up and connected to the E dumper until the next use to ensure the batteries are fully charged. Note that the drive motor is inhibited while the battery charger is plugged into the E dumper socket.

SAFETY

- DO NOT** allow anyone lacking experience to operate your E dumper.
- DO NOT** carry passengers on your E dumper.
- DO NOT** start work without completing the daily maintenance checks.
- DO NOT** operate the E dumper without exercising appropriate safety precautions.
- DO NOT** use other types of battery chargers or batteries.
- DO NOT** pressure wash directly onto the dumper's electronics.

BE SAFE: USE COMMON SENSE AT ALL TIMES.

Specifications

Model	EMD300 4x4	Tipping	Hydraulic power
Power	800W*2 Brushless DC motor	Forward Speed	1: 2.5 km/h
Battery	48V 20Ah Lead-acid Battery		2: 5.3 km/h
	48V 40Ah for option		3: 7.3 km/h
Loading Capacity	300kg	Reverse Speed	2.0 km/h
Wheel	Front 400-8, Rear400-8	Overall Size	1720*712*963mm
Brake	Hydraulic Disk Brake	N.W / G.W	300/350 kg

Features and Controls

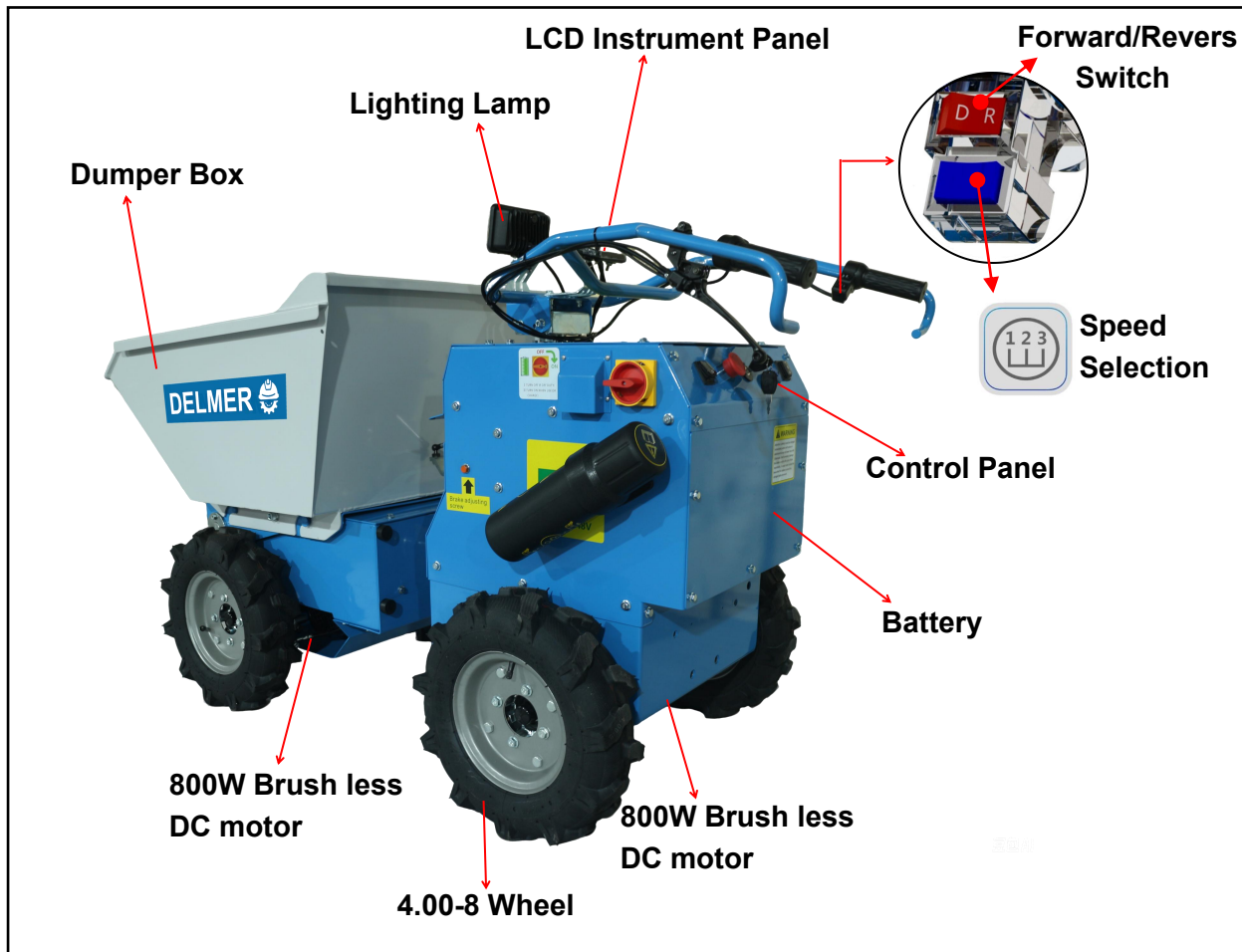

Control Panel

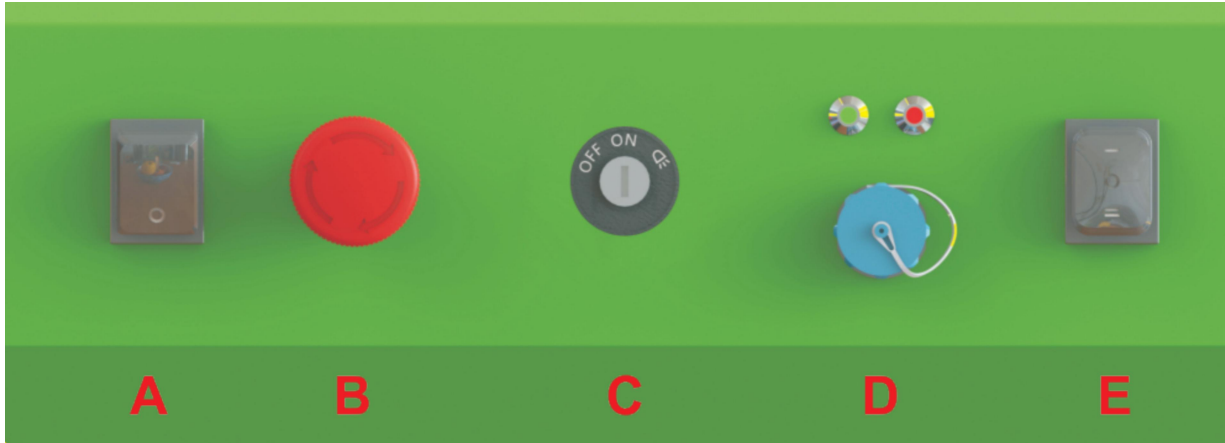

A: Lighting Switch

- Headlight is on
- O Headlight is off.

D: Charging Interface

Charge the battery when it is low.

B: Emergency Stop Button

Press this button in case of emergency to stop the machine.

E: Hydraulic Tipping Switch

— Empty

== Reset

C: Key Switch

Turn the key to the ON/OFF position to control the circuit. The LCD instrument panel will be on when the key is in the ON position. The far-right position is for lighting.

Operating Instructions

Getting Started:

1. For first time use, please switch on the main power.
2. Charge the machine, until the battery symbol full load.



To Move Forward:

1. Turn the key switch to "ON" position.



2. Select the switch "D" on the right control clutch.

3. Select the switch "1" (max speed 2km/h) or "2" (max speed 4km/h) or "3" (max speed 6km/h)

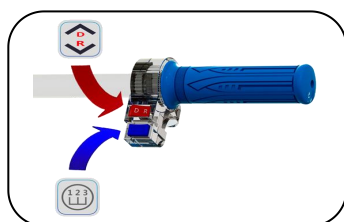

4. Hold the handlebars straight, pull up on the left hand lever & Turn the right handle for the machine to start.

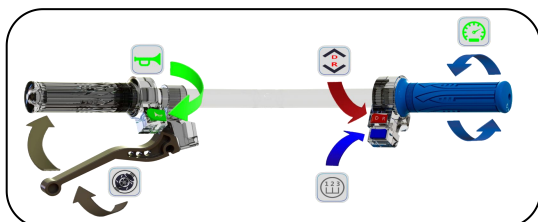

To Reverse:

1. Release the left hand Deadman Lever to stop the E Barrow.

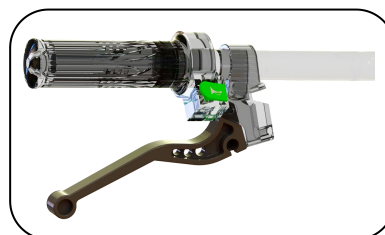

2. Select the switch "R" on the right control clutch.

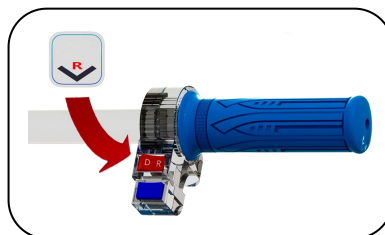

3. Hold the handlebars straight, pull up on the left hand lever & Turn the right handle for the machine to start.

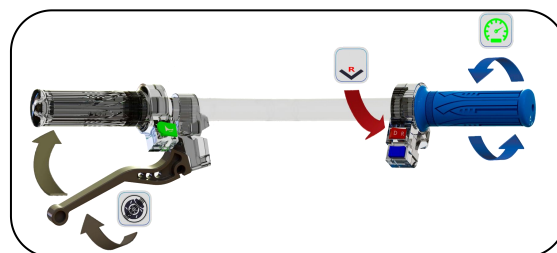

To Stop:

1. Release all the control lever. The E Barrow will slow down and stop. After a short delay the parking brake will automatically come on.
2. Turn the key switch to "Off" position.

To Emergency Stop:

1. Push the red button.
2. Turn the red button to right for reset the emergency stop.



Horn Switch

Press the green horn button when you need a reminder to pedestrians or vehicles.

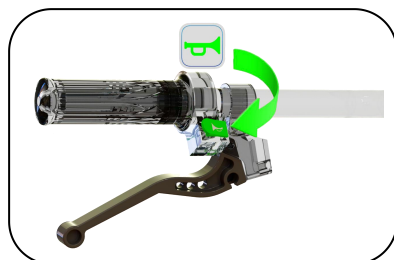

To turn on the Light:

1. Turning the key to the far right will turn on the front light.
2. Under the condition of 1, pressing the black button and the small light will be turned on. If the front light is not turned on, the small top light will not turn on either.

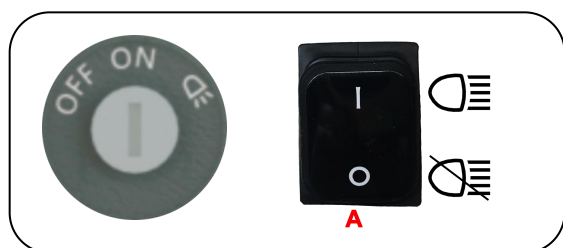

To Empty / Reset Skip:

Stop the machine, press switch E on the panel

- Empty
- == Reset



Please note! Ensure no one is in front of the E dumper.

To Charge the Battery:

Connect the power line with the charging interface, then connect the plug to the main power.

- RED light on - Charging now
- GREEN light on - Charge over

It is better to wait a few hours after it switches to the green light to ensure that the battery is fully charged.



Please Note! Charge the battery immediately when the voltage value on the dashboard drops below 44V. Failing to do so will severely damage the battery and shorten its life cycle. It may even cause the battery to become unchangeable.

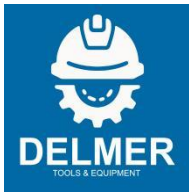

Delmer B.V.
Hogeschoollaan 231
5037 GC Tilburg
The Netherlands

**Tools & Equipment
For Retail and Craftsman**

Maintenance

Routine checks of your E Barrow will ensure trouble free operation with less 'down' time.

Component	Daily	Weekly
State of battery charge	√	
Control Cables	√	
Condition of wiring		√
Tyre Pressure		√
All Nuts/Bolts		√
Brake System		√
Charger		√

Tyre Pressures:

Front Wheel	30 psi
Rear Wheel	30 psi

Remember – A daily check takes only minutes but could save you hours.
Be Proud – look after your E Barrow.

Storage

If the machine will not be used for more than 30 days, consider the following for proper storage:

1. Fully charge the batteries before storage and charge them monthly.
2. Keep the batteries clean and dry. Do not store the machine in a wet environment.
3. Protect the batteries from overheating and flames to avoid explosion hazards.
4. Use clean cloths to wipe the outside of the machine and keep the air vents clear.
5. Store the unit on flat ground in a clean, dry building with good ventilation.
6. Do not expose the electric dumper to direct sunlight during storage.
7. Disconnect the batteries from any electrical circuit and place them in a cool, dry place.
8. Separate the connectors and cables from the terminals before storing the batteries.
9. Always turn off the main power switch during storage.

MACHINE OPERATING

A: Headlight Switch
B: Emergency Stop
C: Key Switch
D: Charging Interface
E: Empty Skip

Right Hand
 Drive/Reverse: ③/④
 Speed Select: ⑤
 Throttle: ②

Left Hand
 Deadman Lever: ①

Tyre Pressure: 25-30 Psi

NO CARRYING PEOPLE

CIRCUIT DIAGRAM

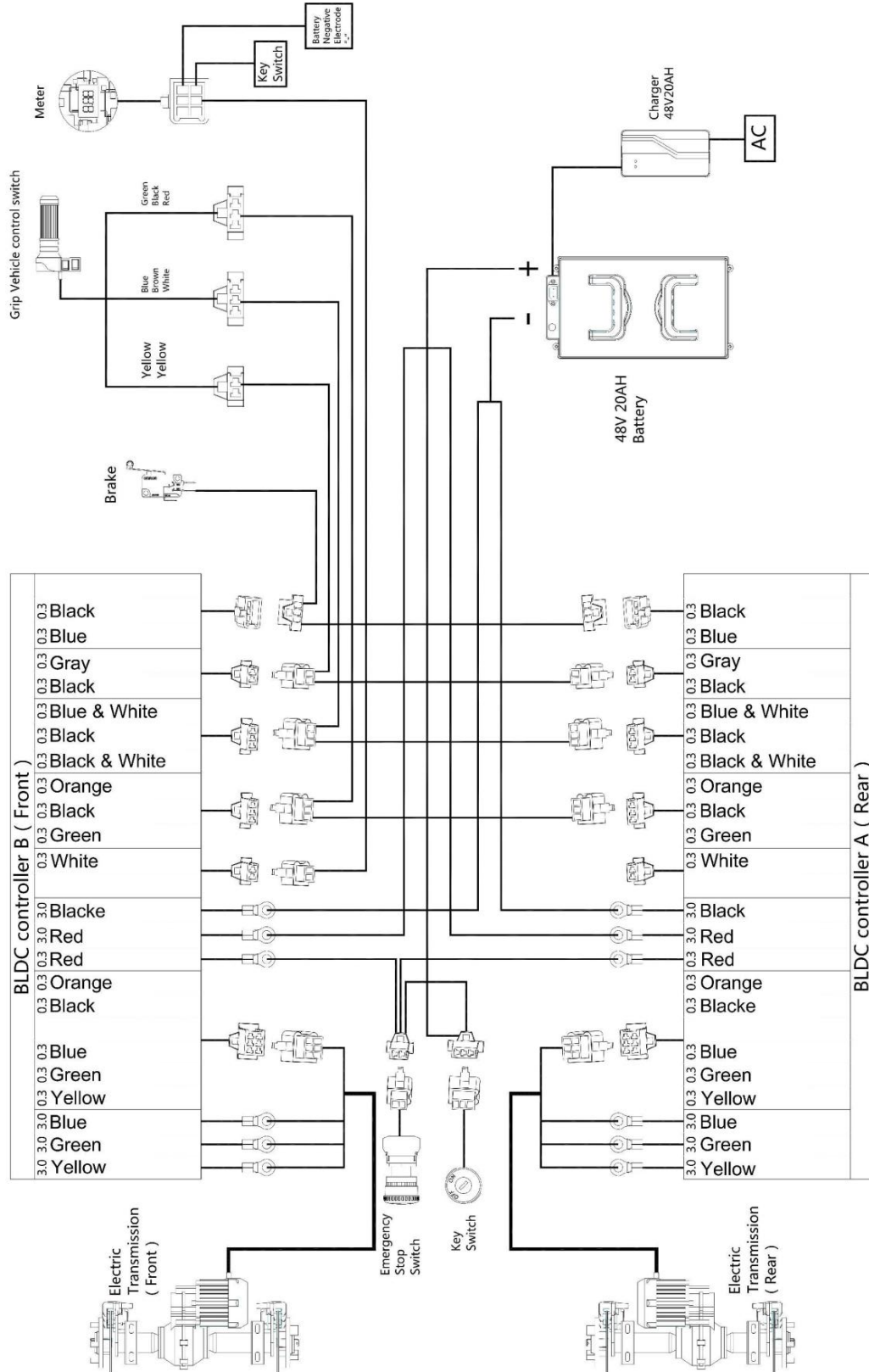

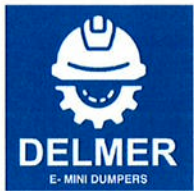

Delmer B.V.
Hogeschoollaan 231
5037GC Tilburg
The Netherlands
VAT: NL865944921B01

E- Mini Dumpers
www.delmer.nl
info@delmer.nl
+31134679127

Svelt Benelux
www.svelt.nl
info@svelt.nl
+31134679127

EU DECLARATION OF CONFORMITY

According to Annex II of Directive 2006/42/EC

Importer and responsible party within the European Union:

Delmer B.V.
Hogeschoollaan 231
5037 GC Tilburg
The Netherlands
VAT No.: NL865944921B01

Declares under its sole responsibility that the following products:

- EMD500 Electric Mini Dumper with Hydraulic Tipping Skip
- EMD500S Electric Mini Dumper with Hydraulic Tipping Skip
- EMD500HL Electric High-Tip Mini Dumper with Hydraulic Tipping Skip
- EMD500HLS Electric High-Tip Mini Dumper with Hydraulic Tipping Skip
- EMD3004X4 Electric 4x4 Mini Dumper with Hydraulic Tipping Skip

are in conformity with the applicable provisions of the following European Directives:

- Directive 2006/42/EC on Machinery (Machinery Directive)
- Directive 2014/30/EU on Electromagnetic Compatibility (EMC Directive)

The products have been assessed in accordance with the following harmonized standards:

- EN ISO 12100:2010 – Safety of Machinery – General Principles for Design, Risk Assessment and Risk Reduction
- EN 60204-1:2018 – Safety of Machinery – Electrical Equipment of Machines
- EN IEC 61000-6-2:2019 – Electromagnetic Compatibility (EMC) – Immunity Standard for Industrial Environments
- EN IEC 61000-6-4:2019 – Electromagnetic Compatibility (EMC) – Emission Standard for Industrial Environments

The above-mentioned products bear the CE marking and are supplied with operating instructions and safety information. Based on the available technical documentation, conformity assessments, risk assessments, electrical safety reports, EMC test reports, and supporting component compliance documentation, including RoHS-compliant lead-acid batteries supplied with the machines, these products comply with the essential health and safety requirements of the above-mentioned European Directives. All supporting documentation is maintained as part of the technical file by Delmer B.V. This declaration is issued under the sole responsibility of Delmer B.V.

Place of Issue: Tilburg, The Netherlands

Date of Issue: 01-10-2024

For and on behalf of Delmer B.V.

Authorized Representative for Product Compliance
Delmer B.V.



Delmer B.V.

Hogeschoollaan 231
5037 GC Tilburg
The Netherlands
+31134679127
info@delmer.nl